

# 广角定焦镜头 YN35mm F1.4 使用说明书

## 感谢您购买永诺产品！

在使用本产品前，请务必先仔细阅读本手册，以确保您能正确、安全使用。请妥善保管好本手册，以便日后能随时查阅。

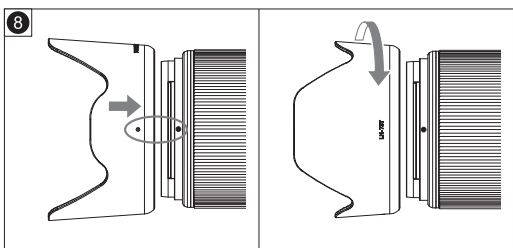
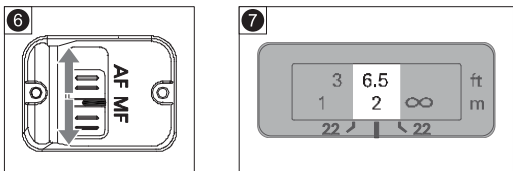
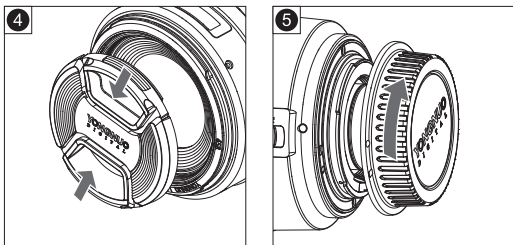
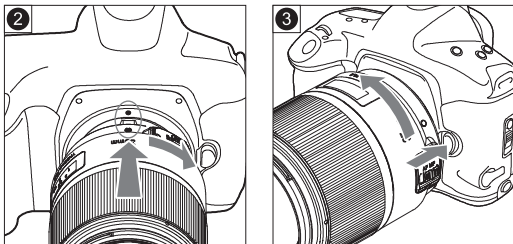
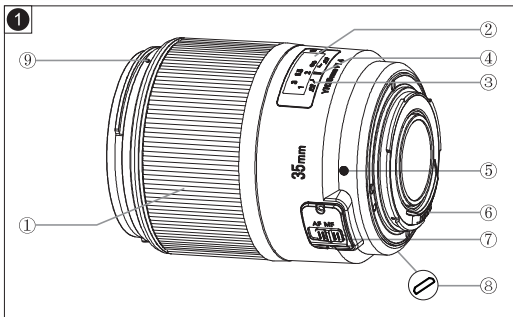

## 安全注意事项

- 请勿透过镜头或相机观看太阳或明亮的光源，否则会使视力受损。
- 无论镜头是否装在相机上，请勿将没有盖镜头盖的镜头置于太阳下，否则镜头可能汇聚光线并引发火灾。不使用时请盖上镜头盖。

## 保养及存放注意事项

- 应避免撞击或直接放置在酷热、极冷或潮湿的环境下。
- 如果长期存放，请选择阴凉凉爽及通风良好的地方。建议远离防虫丸或防虫丸发出气体的地方，以保护镜头的镀膜层。
- 镜片上的污垢或者指纹可用柔软微湿的镜头布或镜头纸清洁，切勿使用溶剂、苯或其他有机清洁剂。
- 本镜头并不防水，下雨或者接近水源使用时须特别小心，切勿弄湿。倘若内部机件、镜片及电子零件因弄湿受损，很可能无法维修。
- 温度突变可能会令镜头表面凝结雾气或水珠，因此在天气寒冷时进入暖和的室内环境，最好将镜头放在密封的塑胶袋内，直至镜头温度接近室温为止。将镜头从温暖的环境拿到寒冷的环境中时，也请使用同样的方法。

## 部件说明 ①

- ①对焦环
- ②对焦距离指示器
- ③景深指示标记
- ④对焦距离指示标记
- ⑤镜头安装标记
- ⑥电子触点
- ⑦对焦模式开关
- ⑧USB接口
- ⑨遮光罩安装标记

## 安装与取下镜头

将镜头上的红色安装标志对准相机上的红色镜头安装标志，然后以顺时针方向旋转镜头 ②，直到听到“咔”的一声为止。如果要卸下镜头，则保持按下相机上的镜头释放按钮，然后朝逆时针方向旋转直至停止转动为止 ③。（详细安装及卸下镜头的步骤请参阅相机使用说明书）

- 卸下镜头后，请将镜头后端朝上放置，以避免划伤镜头表面和电子触点。
- 如果电子触点被弄脏或划伤，可能导致相机和镜头无法正常工作。
- 如果电子触点被弄脏或沾有指纹，请用柔软的布将其擦净。
- 取下镜头时，需要装上防尘盖。请正确安装防尘盖：将防尘盖上的圆形标记对准镜头上的红色安装标记，朝顺时针方向旋转 ⑤。要取下镜头则朝逆时针方向旋转。

## 设置对焦模式 ⑥

自动对焦（AF）：将对焦模式开关设置为AF，然后半按快门进行对焦。

- 对焦过程中,请勿触摸镜头的旋转部分。

手动对焦（MF）：将对焦模式开关设为MF，然后手动转动对焦环进行对焦。

## 景深指示 ⑦

拍摄过程中，您可以依据景深指示了解被摄主体前后的大致清晰范围。

## 遮光罩

安装遮光罩(LH-73T)可以保护镜头和阻挡可能导致杂光或鬼影的散射光线。

将遮光罩上的安装标记对准镜头前端的白色圆点，然后沿箭头所示方向转动遮光罩以将其固定 ⑧。

- 遮光罩安装不当，可能会遮挡部分图像。

## 滤光镜（需另购）

可在镜头前端的螺纹上安装一个直径67mm的滤光镜。

- 每次只能安装一个滤光镜。

## 固件升级

本产品支持固件升级，您可以登录永诺官方网站 [www.hkyongnuo.com](http://www.hkyongnuo.com) 下载最新升级软件和最新固件。使用前，建议升级到最新固件以获取最佳使用体验。

升级方法为：将镜头从相机上取下，通过USB线与电脑连接，然后打开升级软件，按照软件提示完成升级操作。

## 故障排除

### 1、手动对焦时已经调至最清晰，但成像依然是模糊的。

请检查镜头两端镜片是否存在指纹或污垢，如果存在请使用柔软微湿的镜头布或擦镜纸擦拭干净。

### 2、使用自动对焦（AF）拍出来的相片总是跑焦。

部分相机支持对焦微调功能，请进入相应的功能菜单检查对焦微调值是否设置为0，具体设置方法请参阅您的相机说明书。

### 3、镜头装相机上通信异常。

请确保镜头安装到位；请检查镜头触点和相机触点是否被弄脏或划伤，如果被弄脏请用柔软的布将其擦净，如果被划伤请返厂维修。

### 4、其他异常情况。

请尝试关闭相机电源并取出相机电池，然后装回电池再重启电源试试。如果仍有异常，请致电永诺售后服务中心 400-001-3888或发送邮件至 [service@hkyongnuo.com](mailto:service@hkyongnuo.com) 进行咨询。

## 规格

|         |            |        |
|---------|------------|--------|
| 镜头焦距    | 35mm       |        |
| 视角范围    | 对角线        | 66.31° |
|         | 垂直         | 39.82° |
|         | 水平         | 57.03° |
| 镜头结构    | 9组11片      |        |
| 光圈叶片    | 7片         |        |
| 最小光圈    | F/22       |        |
| 最近对焦距离  | 约0.35米     |        |
| 最大放大的倍率 | 约0.15倍     |        |
| 驱动系统    | 直流马达       |        |
| 滤镜直径    | 67毫米       |        |
| 最大直径及长度 | 约φ82×111毫米 |        |
| 重量      | 约810克      |        |

■ 镜头长度是指从安装面到镜头前端的距离。

■ 除特别说明外，尺寸和重量只适用于镜头。

■ 光圈设置可以由相机指定。

本说明书最新电子版可在永诺官方网站[www.hkyongnuo.com](http://www.hkyongnuo.com)获取。

本使用说明书中的功能及数据均是依据本公司的测试条件获得。设计和规格如有变更，恕不另行通知。

本使用说明书中的永诺（YONGNUO）徽标是深圳市永诺摄影器材股份有限公司在中国或/和其他国家（地区）的注册商标或商标。其他所有商标均为其各自所有者拥有。

深圳市永诺摄影器材股份有限公司

地址：深圳市坪山区坑梓街道深福保现代光学厂区A座

电话：（086）0755-8376 2448

邮箱：[service@hkyongnuo.com](mailto:service@hkyongnuo.com)

网址：[www.hkyongnuo.com](http://www.hkyongnuo.com)

全国服务电话：400-001-3888

# WIDE-ANGLE PRIME LENS YN35mm F1.4

## USER MANUAL

### Thank you for purchasing YONGNUO product!

Before using the product, please read the instruction manual carefully to ensure that you use the product properly. Please keep the manual properly for future reference.

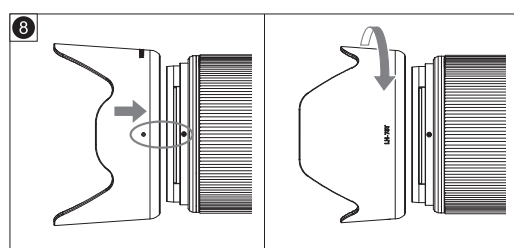
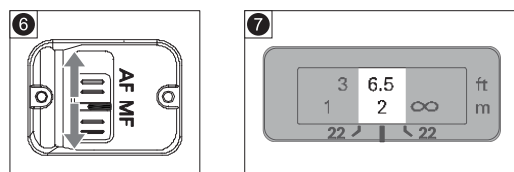
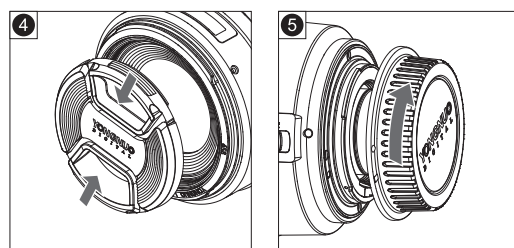
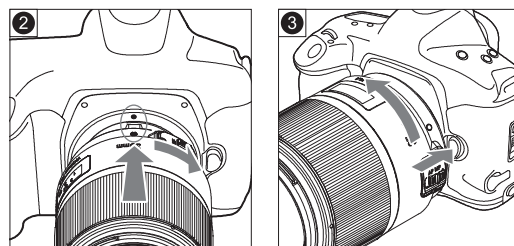
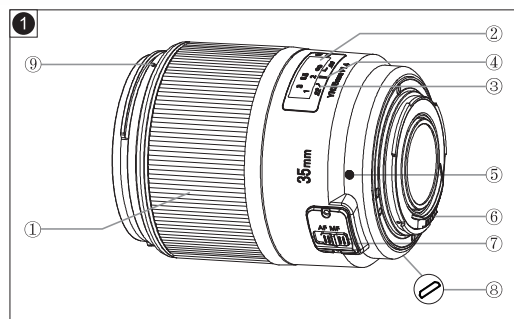

### Precautions

- \* Do not stare at the sun or a bright light source through the lens or camera, otherwise it may result in impairment of sight.
- \* Whether the lens installed on the camera or not, do not place the lens which without lens cover in the sun. Otherwise the lens may gather light and result in a fire. When not in use, please cover the lens cover.

### Maintenance and Saving Precautions

- \* Should avoid collisions or placed directly in extreme heat, cold or wet environment.
- \* For long-term storage, please select the cool, dry and ventilated place. In order to protect the film of lens, it is suggested that far from the insect-resistant pill or insect pill emit gases.
- \* Contaminant or fingerprint on the lens can be cleaned with slight damp soft cleaning cloth or lens paper, do not use solvents, benzene or other organic cleaner.
- \* The lens is not waterproof, rain or close to the water must be especially careful when using, do not get wet. If the internal parts, lens and electronic components was damaged due to wet, it may cause unlikely to repair.
- \* Temperature mutations could make the surface of the lens condense to fog or water droplets, so when the weather was cold into a warm indoor environment, it is suggested to place the lens into the sealed plastic bag, until the lens temperature close to room temperature. When the lens from the heat to the cold environment, also please use the same method.

### Working Parts Introductions 1

- ① Focusing ring
- ② Focus distance indicator
- ③ Depth of field indicator mark
- ④ Focus distance sign
- ⑤ Lens mounting mark
- ⑥ Electronic contact
- ⑦ Focus mode switch
- ⑧ USB port
- ⑨ Lens hood mounting mark

### Install and Discharge the Lens

Install the lens with the red mounting mark direct at the white lens mounting mark of the camera, then rotate the lens in clockwise direction until hearing the sound of "click" ②. If you want to discharge the lens, rotate the lens in counterclockwise direction until it stop running ③. (For the detailed steps of lens installation and discharge please refer to the camera instruction manual)

- \* After discharging the lens, please place the lens back-end upwards to avoid scratch the lens surface and electronic contact.
- \* If the electronic contact is smeared, scratched, or stained with fingerprint, may cause corrosion or poor contact. The camera and lens might not work properly.
- \* Please use soft cloth to wipe it if the electronic contact is smeared or stained with fingerprint.
- \* When taking off the lens, please install the dust cover. Please install the dust cover properly: Make the mounting mark on the dust cover direct at the red mounting mark of the lens, and rotate in clockwise direction ⑤. While rotate in counterclockwise direction to take down the dust cover.

### Focus Mode Setting 6

Auto-focus (AF) : sets the focus mode switch to AF, then half press the shutter AF.

- \* In the process of focus, please do not touch the rotating parts of the lens.

Manual focus (MF) : the focus mode switch is set to MF, then turn the focusing ring to focus in the manual.

### Depth of Field Indicator 7

Filming process, you can get the clear scope before and after the main subject according to the depth of field indicates.

### Lens hood

Install the lens hood (LH-73T) can protect the lens and block the scattering light which may result in stray light or ghost shadow. Align the lens hood's attachment position mark with the white dot on

the front of the lens, then turn the lens hood in the direction of the arrow to secure it ⑧.

- \* Improper install the lens good may keep out part of the image.

### Filter (optional accessories)

You can install a 67mm filter via the lens front mounting screw thread. Only one filter can be installed each time.

### Firmware Upgrade

This product supports firmware upgrade, please visit YONGNUO official website [www.hkyongnuo.com](http://www.hkyongnuo.com) to download the latest upgrade software and latest firmware. Before use, it is suggested to upgrade to the latest firmware for best user experience.

The upgrade method, take the lens out of the camera, connect the lens with computer via USB cord. Open the upgrade software and upgrade the lens according to the software prompts.

### Troubleshoot

**1. In spite it has been adjusted to most clear by manual focus, the image is still vague.**

Please check if the contaminant or fingerprint on the both sides of the lens, if exist please clean with slight damp soft lens cloth or lens paper.

**2. Always lose focus when using Auto focus to take photos.**

Part of the cameras supports fine tuning function. Please enter into the function and make sure the focus fine-tuning value is set to 0, for the detail setting method, please refer to your camera manual.

**3. Abnormal communication when the lens installed on the camera.**

Please make sure the lens in proper installation; Please check if the contact on the lens and camera is dirty or scratched or not. Please use soft cloth to wipe if it is dirty. Please return to factory for maintenance if with scratches.

**4. Other abnormal phenomena.**

Please try to turn off the camera and take out the battery, then install the battery to restart the power supply. If there are still abnormal, please contact YONGNUO after-sale service center 400-001-3888 or send email to [service@hkyongnuo.com](mailto:service@hkyongnuo.com).

### Specification

|                          |            |                                 |
|--------------------------|------------|---------------------------------|
| Focal length             |            | 35mm                            |
| Angle of view            | Diagonal   | 66.31°                          |
|                          | Vertical   | 39.82°                          |
|                          | Horizontal | 57.03°                          |
| Lens construction        |            | 9 groups 11 elements            |
| Aperture blades          |            | 7 blades                        |
| Minimum aperture         |            | F/22                            |
| Min. focusing distance   |            | Approx. 0.35m                   |
| Max. magnification       |            | Approx. 0.15 times              |
| Driving system           |            | Direct current motor            |
| Filter diameter          |            | 67mm                            |
| max. diameter and length |            | Approx. $\phi 82 \times 111$ mm |
| Weight                   |            | Approx. 810g                    |

- The lens length refers to the distance from the mounting side to the lens front end.
- Unless special stated, the dimension and weight is only suitable for lens.
- The Aperture can be specified by the camera.

The electronic edition of this user manual can be acquired from [www.hkyongnuo.com](http://www.hkyongnuo.com).

The functions and data of this manual are based on test conditions of our company. If any changes in the design and specifications will without notice. The YONGNUO logo in this manual is the trademark of Shenzhen YONGNUO Photographic Equipment Co., Ltd. and registered trademark in China or/and other countries (regions). All other trademarks are the property of their respective owners.

Shenzhen YONGNUO Photographic Equipment Co., Ltd.  
Address: Building A, Shenfubao modern optics factory, Kengzi Street, Pingshan District, Shenzhen, China  
Phone: (86) 0755-8376 2448  
Website: [www.hkyongnuo.com](http://www.hkyongnuo.com)  
Email: [service@hkyongnuo.com](mailto:service@hkyongnuo.com)  
Hotline: 400-001-3888