

Pro LED Video Light

在使用产品前，请认真阅读说明书并妥善保管以便将来查阅。

- 1、贴片LED与RGB全彩完美结合的摄像灯，让您的创作更加丰富多彩。
- 2、内置5200mAh电池，结合快速充电芯片，充电时间短，使用时间长。无需安装电池，方便您外景拍摄等情况下使用。
- 3、主灯光采用192颗超大发光角度、超高显指的贴片LED，色彩还原真实自然。
- 4、采用永诺专有LED驱动技术，拍摄时绝不出现波纹、频闪等现象。
- 5、采用编码器数字调光，可分粗调、细调模式，使用更方便。
- 6、采用LED数字显示屏，功率输出更直观。
- 7、支持外接直流电源输入，使用的同时也对内置电池充电，方便您长时间拍摄使用。

使用永诺电源适配器，以获得摄像灯的长时间工作。当使用外接电源时，摄像灯工作功率不超设定功率的同时，将会给内置电池充电，直到电池充满电；充电模式下内置电池充电80分钟就可充至80%的电量，满电情况下可以连续使用120分钟。电源接口为内正外负，输入电压为12伏，电流为2安。

注：如使用其他电源适配器造成的产品故障，不予保修。

Diagram illustrating the front and back views of the device with numbered callouts:

- 1: LED display
- 2: RGB button
- 3: RGB button
- 4: Fire/Glow button
- 5: Fire/Glow button
- 6: Battery level indicator
- 7: Bat button
- 8: 3200K/5500K button
- 9: Headset jack
- 10: Headset jack

- ①：DC供电模式
②：电池供电模式
○：关机

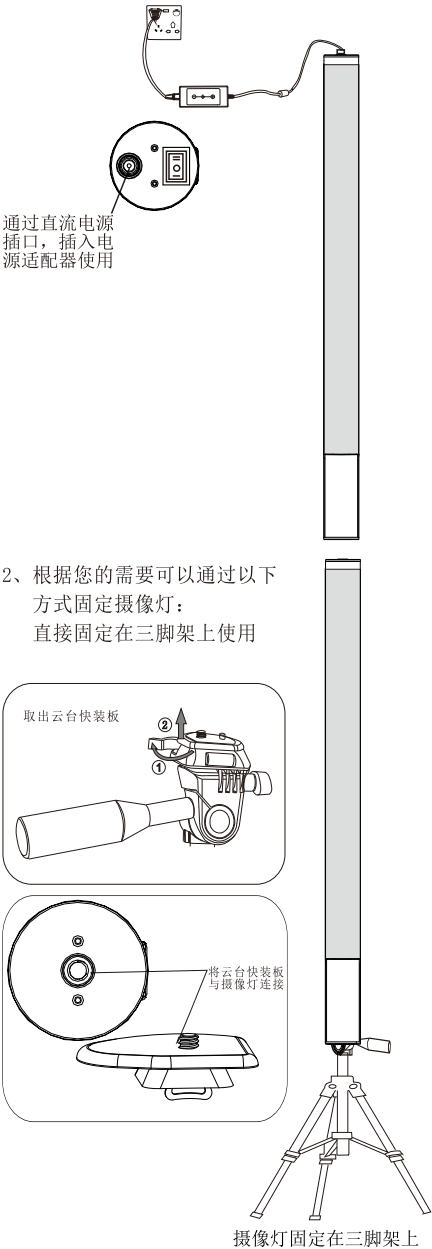

(旋转调节亮度)

可分粗调、细调模式，使用更方便。
按下粗/细调切换按钮进行亮度粗细调的切换，选择Coarse时则进入粗调模式亮度按10%为一个调节单位，再按下此按钮，选择Fine时则进入细调模式亮度按1%为一个调节单位。

粗调模式

细调模式

光源	192颗贴片LED与40颗RGB贴片灯		
色温	5500K和RGB全彩		
显色指数	大于或等于95	遥控距离	小于15米
输出功率	18瓦和8瓦	手机遥控	蓝牙4.0
流明值	2400LM和494LM	平均寿命	50000小时
重量	1134克	光照角度	110°
内置电池	5200mAh		
外接电源	12伏2安直流电源		
体积	595*70*70毫米		
所含物品：摄像灯（1）、说明书（1）、收纳袋（1）			
注：如有缺失请与经销商联系			

光源	192颗贴片LED与40颗RGB贴片灯		
色温	3200K、5500K和RGB全彩		
显色指数	大于或等于95	遥控距离	小于15米
输出功率	18瓦和8瓦	手机遥控	蓝牙4.0
流明值	2400LM和494LM	平均寿命	50000小时
重量	1134克	光照角度	110°
内置电池	5200mAh		
外接电源	12伏2安直流电源		
体积	595*70*70毫米		
所含物品: 摄影灯 (1)、说明书 (1)、收纳袋 (1)			
注: 如有缺失请与经销商联系			

故障	原因	处理方法
打开电源开关完全无反应	电池电量不足	进行充电或外接电源使用
	电路板损坏	返厂维修
亮度不足，调至最亮仍然很暗	电池电量不足	进行充电或外接电源使用
测试电量不准确，调高亮度时显示亮度，调低亮度后电量又满了	电池电量测试所指示的是，当前亮度下能使用的时间长短。调高亮度后，需要的电量更多，所以使用的时间变短，电量显示变少了	属于正常现象，无需处理
手机无法遥控摄像灯	距离太远	遥控的距离在15米内

深圳市永诺摄影器材股份有限公司
地址：深圳市坪山区坑梓街道深福保现代
光学厂区A座
电话：0755-8376 2448
网址：www.hkyongnuo.com
售后电话：400-0013-888



YN260

Pro LED Video Light

(General user manual 5500K color temperature and 3200K-5500K color temperature)

Before using this product, please read this user manual carefully and keep it properly for reference.

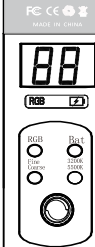

I. Product Structure

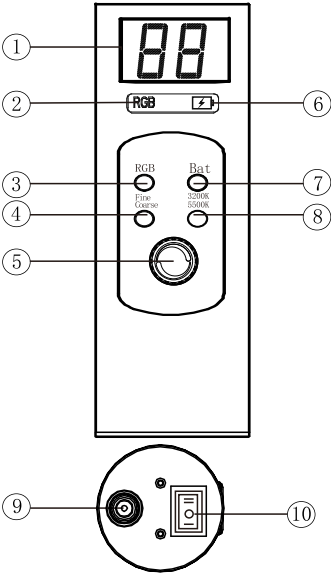

- LED digital display screen
- RGB color light
- RGB color switch button
- Fine/Coarse button
- Brightness adjustment encoder
- Charging indicator light
Light on: charging
Light off: fully charged, or the service power of the LED light exceeds the output power of the AC adapter, the device stops charging.
Note: Turn down the brightness to restore to charging state.
- Battery capacity testing button (Batt button)
- 3200K/5500K color temperature button
(5500K color temperature version this button is: 5500K color temperature button)
- Power switch/ Luminance adjusting knob
- power switch
①: DC supply mode.
②: Battery supply mode.
③: Off.

II. Function Introduction

- The video light with Piece of SMD LEDs and full color RGB SMD lamps perfect integrated, which allows your creation colorful.
- Equipped with built-in 5200mAh battery, combined with the quick charged chip, short charge time and long use time. It is no need to install the external battery, which convenient for outdoors use.
- The main light adopts 192 pieces of extra-large luminous chips, the high display index Piece of SMD LEDs makes the color restore truly and naturally.
- YN260 adopts encoder digital dimming system, including coarse tuning mode and fine tuning mode.
- On the LED digital display screen of YN260, the parameter of the power output is intuitive.
- Shooting for long time is possible because YN260 supports external DC power input (power adapter is optional).
- Supports external DC power input, it will charge the built-in battery when in use, which will be convenient for your long time photographic use.

III. Method of Application

- External Power Supply
Using YONGNUO AC adapter for long use of the LED light. When using the external power source, if the operating power of the LED light does not exceed the setting power, the built-in battery will be charged until it is fully charged. In charging mode, 80% of battery capacity of the built-in battery can be done within 80 minutes. At full battery capacity, the YN260 can be used continuously for 120 minutes. For power port, it is positive inside and negative outside, the input voltage is 12V, the electric current is 2A. Note: This video light is not under guarantee if the malfunction is caused by using DC adapter of other brand.

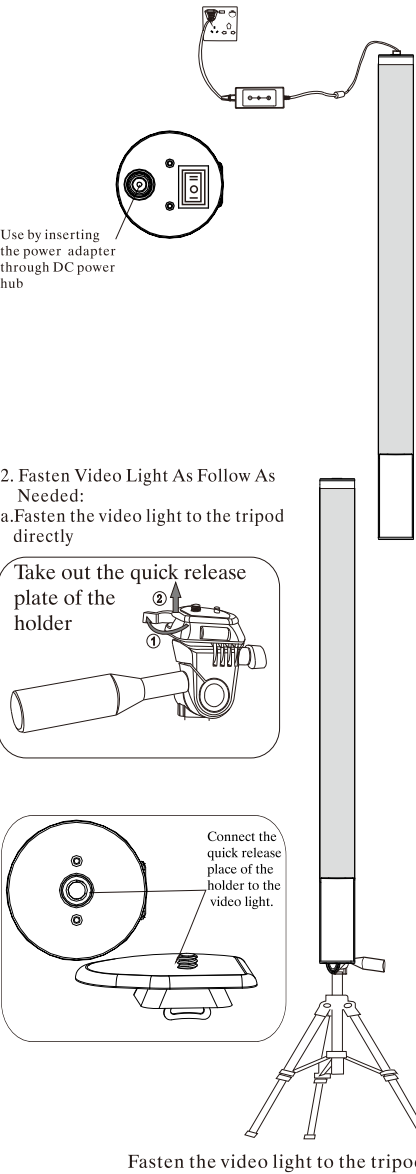

- Start up & Shut down and Brightness adjustment
a. Press the power switch, the LED camera light enabled, rightwards rotate to increase the brightness, or leftwards rotate to reduce the brightness.

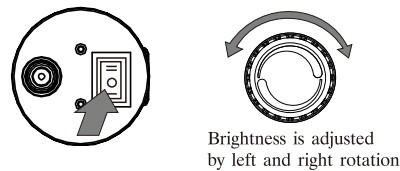

- RGB color switch button
Press the button when the red light is on, the luminance of red light can be adjusted; when the green light is on, the luminance of green light can be adjusted; and when the blue light is on, the luminance of blue light can be adjusted. It can acquire different color by changing the luminance ratio of the three colors. Note: the RGB color mode and the 3200K/5500K color temperature mode can not be used at the same time.

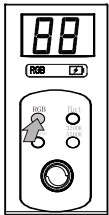

Switching color mode

- 3200K, 5500K color temperature switch button
It can get the color temperature between 3200K to 5500K by changing the luminance ratio of the two color temperature. Note: the RGB color mode and the 3200K, 5500K color temperature mode can not be used at the same time.



Switch to 3200K/5500K color temperature mode

- Fine/Coarse button
Equipped with coarse and fine adjusting mode, which will be more convenient for use. Press the Coarse/Fine button to conduct to Fine/Coarse adjustment, when the indicator light of Coarse bright, it will enter into coarse adjusting mode, the luminance will be adjusted with 10% as an adjusting grade. Then press the button to switch to fine adjusting, the luminance will be adjusted with 1% as an adjusting grade.

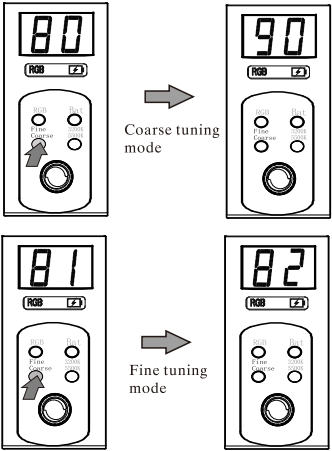

- Battery capacity testing button (Batt button)
Press the electric quantity testing button for electric test, the LED display shown is the battery capacity. The readings can be divided into P0-P9 which indicates 0%-90% of the electric quantity. The readings as the picture shown indicate the electric quantity is 30%. (Note: the rest electric quantity of test when the brightness is low is different from that of the test when the brightness is high, the service life is tested under the current brightness).

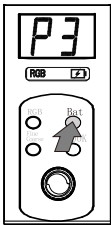

The digital tube display is the battery electricity quantity

IV. Product Specification

*5500K color temperature

Light Source	192 Piece of SMD LEDs and 40 RGB SMD lamps		
Color Temperature	5500K and RGB full color		
Color Rendering Index	≥95	Control distance	<15M
Output power	18W and 8W	Mobile control	Bluetooth 4.0
Lumen	2400LM and 494LM	Average Service Life	50000H
Weight	1134G	Luminance Angle	110°
Compatible batteries	5200mAh		
External power source	12V 2A DC power supply		
Size	595*70*70MM		
Contents : Video light (1)、User Manual (1)、Storage bag (1) Note: Please contact your dealer if anything missing.			

*3200K-5500K color temperature

Light Source	192 Piece of SMD LEDs and 40 RGB SMD lamps		
Color Temperature	3200K、5500K and RGB full color		
Color Rendering Index	≥95	Control distance	<15M
Output power	18W and 8W	Mobile control	Bluetooth 4.0
Lumen	2400LM and 494LM	Average Service Life	50000H
Weight	1134G	Luminance Angle	110°
Compatible batteries	5200mAh		
External power source	12V 2A DC power supply		
Size	595*70*70MM		
Contents : Video light (1)、User Manual (1)、Storage bag (1) (1) Note: Please contact your dealer if anything missing.			

V. Mobile APP Remote Control

The product supports mobile remote control, the APP can be downloaded from the YONGNUO official website or download through scanning the two-dimension code on the gift box, Mobile phone APP will be updated continuously. Please pay attention to YONGNUO official website for latest version of APP to get better remote control experience.

VI. Failure Analysis and Troubleshooting

When using this product, you may encounter the following problems

Description	Cause	Troubleshooting
No reaction after power on	Low Battery	recharged or connect external power supply
	Damaged circuit board	Depot repair
Inadequate or low luminance at the greatest luminous intensity	Low battery	recharged or connect external power supply
Inaccurate battery capacity test: low battery in high luminance and full battery in low luminance.	The battery capacity indicates the length of time available for the use in the current luminance. Higher luminance required more power and the length of time available for use will be shortened, so the battery capacity shown gets lower	Normal phenomenon and no measure needed
The mobile phone could not remote control the video light	Too far away	Ensure the remote control distance is no more than 15 meters

SHENZHEN YONGNUO PHOTOGRAPHY EQUIPMENT Co.Ltd.
Add: Building A, Shenfubao modern optics factory, Kengzi Street, Pingshan District, Shenzhen
TEL: 0755-8376 2448
Wed: www.hkyongnuo.com
After-sales Service TEL: 400-0013-888