

YN300Air II

摄像机 Pro LED Video Light 使用说明书

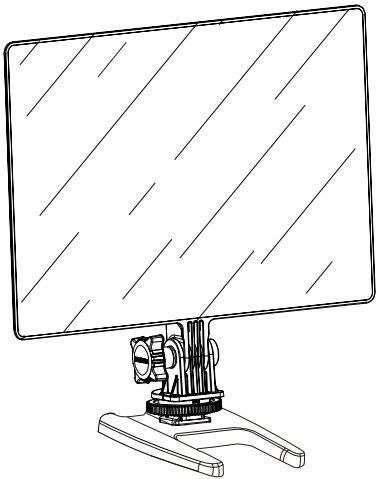

感谢您使用YN300Air II摄像机，在使用产品前，请认真阅读说明书并妥善保管以便查阅。

功能简介

- YN300Air II是永诺全新LED摄像机，产品补光亮度和补光范围更加强大；调节RGB模式更简单，满足您的各类补光需要。
- YN300Air II采用108颗高显指贴片LED和100颗RGB全彩贴片灯相结合的补光效果。
- YN300Air II配置专有多频道无线遥控器,可通过遥控器触摸屏轻松调节RGB模式，RGB模式调节更加简便。同时支持8组摄像灯的分频控制。
- YN300Air II支持双电源输入，支持NP-F系列电池和外接直流电源，满足你各类环境的使用需要。
- YN300Air II采用永诺专有的LED恒流驱动技术，拍摄时摄像灯绝不出现波纹、频闪等现象。
- YN300Air II配置丰富的特效情景模式，更加贴近用户的创作需求。

注意事项

- 使用时请将摄像灯处于通风环境，并保持摄像灯散热孔不被堵塞。
- 请勿私自拆卸产品，如产品出现故障须本公司或授权维修人员处理。
- 设备运行时请不要近距离直视光线。
- 请勿在易燃易爆和暴露在雨中使用。
- 请勿让儿童接触本产品。

产品规格

| | | | |
|---|----------------------|------|---------|
| 光源 | 108颗贴片LED与100颗RGB贴片灯 | | |
| 色温 | 3200K、5600K和RGB全彩 | | |
| 输入功率 | 18W和18W | 遥控距离 | 小于15米 |
| 流明值 | 2268LM和1235LM | 平均寿命 | 50000小时 |
| 重量 | 约530克 | 光照角度 | 110° |
| 适用电池 | 1个NP-F系列锂电池 | | |
| 外接电源 | 12伏2安直流电源 | | |
| 体积 | 216*187*52毫米 | | |
| 所含物品：摄像灯（1）、说明书（1）、手柄（1）、灯脚（1）、微型底座（1）、遥控器（1）。 注：如有缺失请与经销商联系 | | | |

产品结构

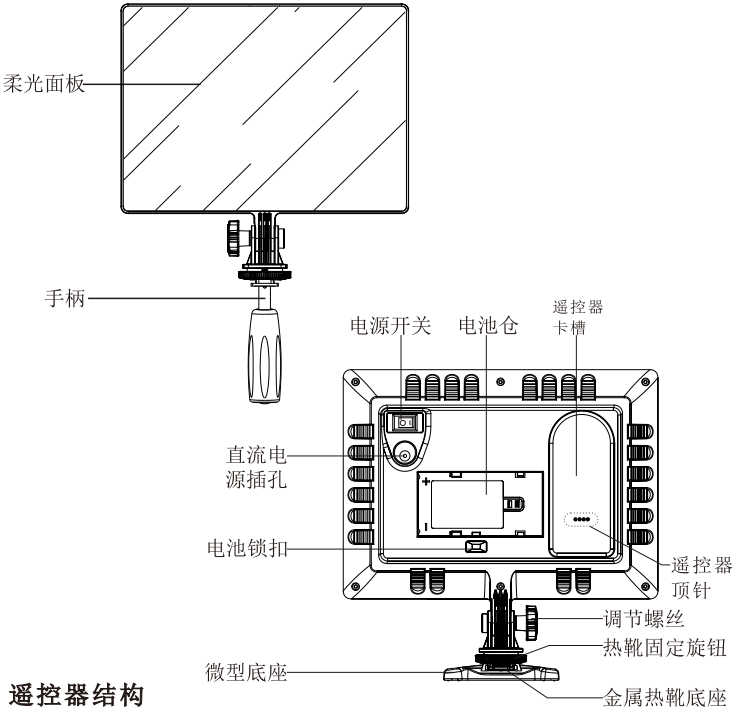

遥控器结构

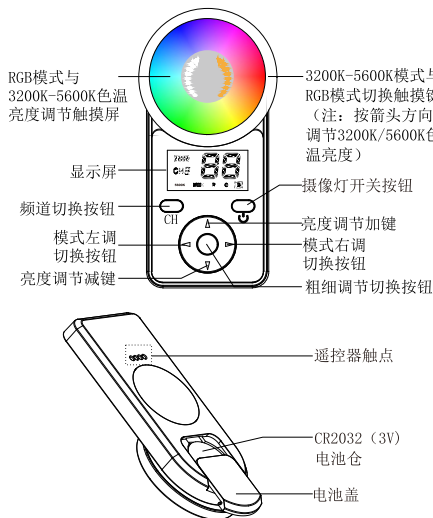

安装和固定

1、安装电池

a、安装锂电池时按箭头方向将电池装入卡槽。

注：适用NP-F系列电池，不使用时请取下电池。

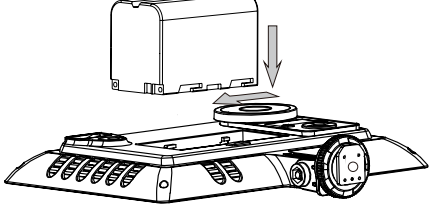

b、拆卸锂电池时，请先按下电池锁扣再取出锂电池。

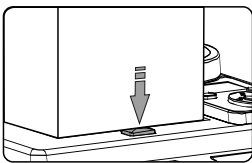

2、安装摄像灯

先将灯脚通过梅花胶头螺丝固定在摄像灯底部，根据您需要的方向调节摄像灯的角度。

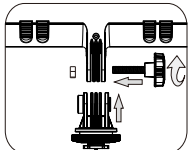

3、根据您的需要可以通过以下方式固定摄像灯：

a、固定在单反相机/摄像机热靴上使用。

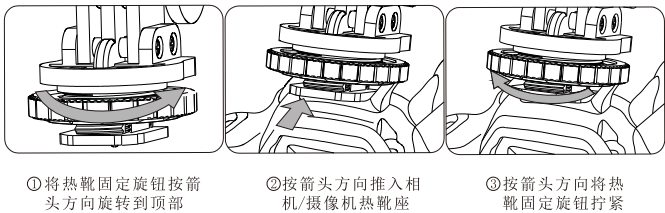

b、通过附带的微型底座放置在桌面或者其他平面上使用

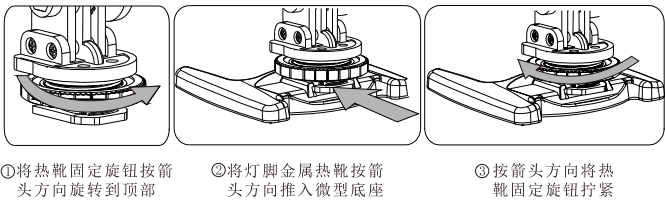

4、外接电源供电

可选购永诺电源适配器，以获得摄像灯的长时间工作。当使用外接电源时，摄像灯将自动切断电池供电且不对电池充电。电源接口为内正外负，输入电压为12伏,电流为2安。

注：如使用其他电源适配器造成的产品故障，不予保修。

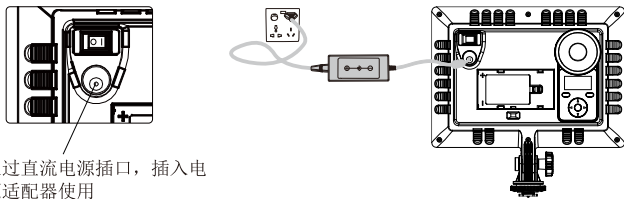

5、遥控器插入摄像灯卡槽使用

当遥控器无安装电池时将遥控器插入摄像灯卡槽让遥控器磁铁与摄像灯磁铁吸合便可使用，如需远程控制摄像灯，需给遥控器安装一个CR2032电池。

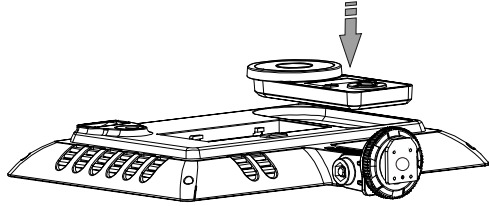

使用方法

1、开关机按钮

先安装电池或插入DC电源,再按电源开关，LED摄像灯点亮，使用遥控器调节摄像灯的亮度。注：RGB颜色与3200K-5600K色温是不能同时使用的。

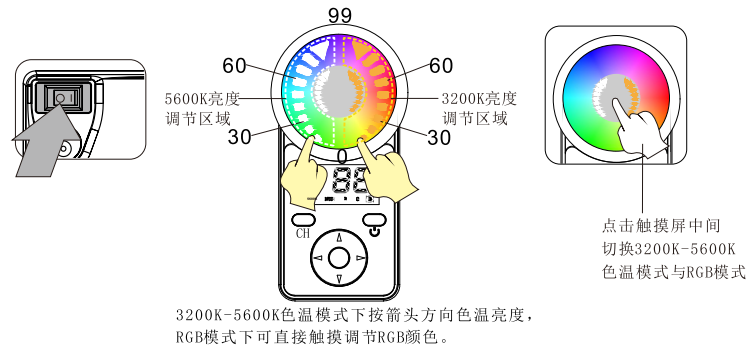

2、电量测试

将遥控器插入摄像灯卡槽，此时遥控器显示的是给摄像灯供电的电池电量；如下图电池的电量为41%至60%。

注：低亮度时测试与高亮度时测试剩余电量是不相同的，测的是当前亮度下，可以使用时间的长短。

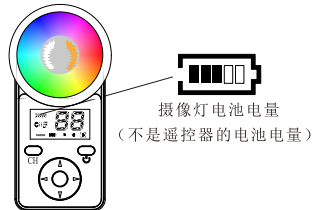

3、粗/细调模式

粗调、细调模式,使用更方便。按下遥控器粗、细调节切换按钮按钮进行粗细调的切换,切换到Coarse模式亮度按10%为一个调节单位,再按下此按钮切换到Fine模式亮度按1%为一个调节单位。注：长按2秒粗/细调按钮，锁定触摸屏，不被误触；再次长按解锁。

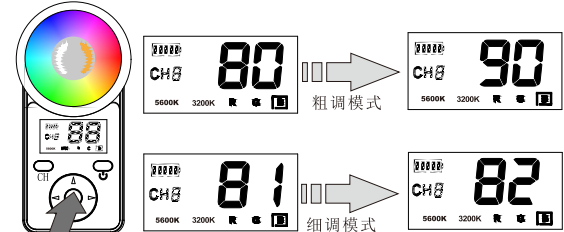

4、切换色温模式

按下遥控器左、右按钮切换色温模式。

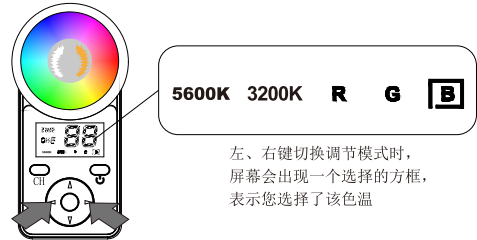

5、频道切换按钮

a、将遥控器插入摄像灯卡槽，短按遥控器CH键,摄像灯与遥控器同步CH+,遥控器切换到你所需要的频道,当您取下遥控器时摄像灯保留与遥控器一致的频道。

b、假设此时遥控器切换至频道H2,则此时摄像灯的频道也是CH2，取下遥控器后摄像灯的频道将是CH2。只能遥控器插入摄像灯卡槽才可以切换摄像灯的频道。

c、如您购买多台此型号的摄像灯，可以分组控制亮度与开关,最多可分8组。（遥控器液晶屏可以显示有CH1-8的数字每个数字则对应相应的频道，通过CH按钮来切换频道）。

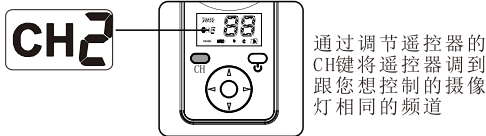

6、特殊场景补光模式

a，长按CH按键2秒进入特殊场景模式，显示F0。

b，短按CH按键切换F0-F9（10种场景）或左右按键切换10种不同的模式

c，短按粗/细调切换键暂停或启动特殊场景补光。

d，长按CH按键退出或关机退出。

F0，模拟闪电 F5，红绿蓝快速循环

F1，模拟电影荧幕反光 F6，红绿蓝慢速循环

F2，模拟烛光 F7，模拟警车灯光

F3，模拟日出 F8，模拟救护车灯光

F4，模拟烟花 F9，模拟消防车灯光

故障分析及排除

在使用过程中，您可能遇到以下问题：

| 故障 | 原因 | 处理方法 |
|--------------------------------|---|--------------|
| 打开电源开关完全无反应 | 电池电量不足 | 使用新电池或外接电源使用 |
| | 电路板损坏 | 返厂维修 |
| 亮度不足，调至最亮仍然很暗 | 电池电量不足 | 使用新电池或充电后使用 |
| 测试电量不准确，调高亮度时显示低电量，调低亮度后电量又满格了 | 电池电量测试所指示的是:当前亮度下能使用的时间长短。调高亮度后，需要的电量更多，所使用的时间变短，故电量显示变少了 | 属于正常现象，无需处理 |
| 无法遥控摄像灯 | 距离太远 | 遥控的距离在15米内 |
| 遥控器按钮调节有反应，RGB触摸调节摄像灯无反应 | 遥控器电池电量较低 | 给遥控器更换新电池 |

本手册中的功能是依据本公司的测试条件获得，设计和规格如有变更，恕不另行通知。
深圳市永诺摄影器材股份有限公司
地址：深圳市坪山区坑梓街道深福保现代光学厂区A座
电话：0755-8376 2448
网址：www.hkyongnuo.com
售后电话：400-0013-888

YN300Air II
Pro LED Video Light
User Manual

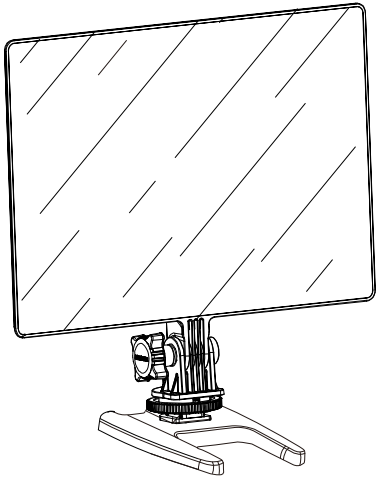

Thank you for using the YN300Air II LED video light. Please read the manual carefully and keep this user manual properly for reference.

Function Introduction

- 1.YN300Air II is YONGNUO brand new LED video light which brings you a more powerful fill light brightness and more wider fill light range, with easier RGB mode adjustment to meet your various fill light needs.
- 2.YN300Air II uses a combination of 108 high-definition lamp beads and 100 RGB full-color patch lights.
- 3.The 300Air II is equipped with a proprietary multi-channel wireless remote control that easily adjusts the RGB mode via the remote control touch screen, making RGB mode adjustment easier. At the same time, it supports the frequency division control of 8 groups of video lights.
- 4.YN300Air II supports dual power input, supports NP-F series battery and external DC power supply, to meet the needs of your various environments.
- 5.YN300Air II adopts YONGNUO proprietary LED constant-current drive technology, will not appear ripples or stroboscopic phenomena during the shooting.
6. YN300Air II is equipped with rich special effects and scene modes, which are more close to users' creation needs.

precautions

- 1.This product should be used under the ventilated environment. Please make sure the heat emission hole won't be blocked when you are using this speed-lite.
- 2.Do not disassemble the product, maintenance or repair of this product should be carried through by technical maintenance personnel of our company or technical maintenance personnel authorized.
- 3.When the equipment is running, do not look into the light directly and closely.
- 4.Do not use this product in flammable and explosive place, or where it can be exposed to moisture.
- 5.Please keep this product away from the children.

Product Specificaion

| | | | |
|--|-------------------------------------|----------------------|--------|
| Light Source | 108 LED beads and 100 RGB SMD lamps | | |
| Color Temperature | 3200K、 5600K and RGB full color | | |
| Input power | 18W and 18W | Control distance | <15M |
| Lumen | 2268LM and 1235LM | Average Service Life | 50000H |
| Weight | About 530G | Luminance Angle | 110° |
| Compatible batteries | One NP-F series lithium batteries | | |
| External power source | 12V2A DC power supply | | |
| Size | 216*187*52mm | | |
| Contents : Video light (1)、 User Manual (1)、 Handle(1)、 Light base(1)、 Micro base(1)、 Remote Controller(1). Note: Please contact your dealer if anything missing. | | | |

Product Structure

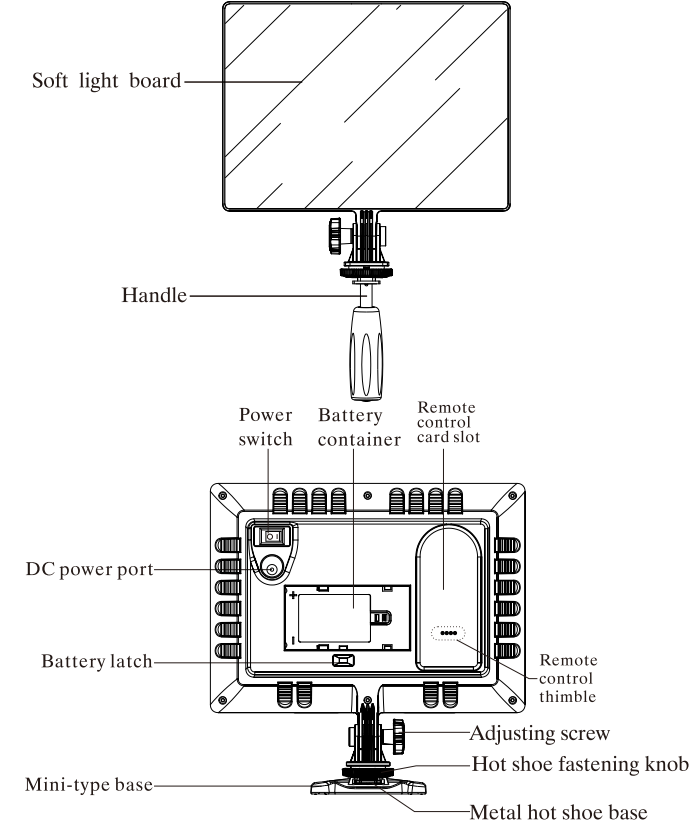

Remote Controller Structure

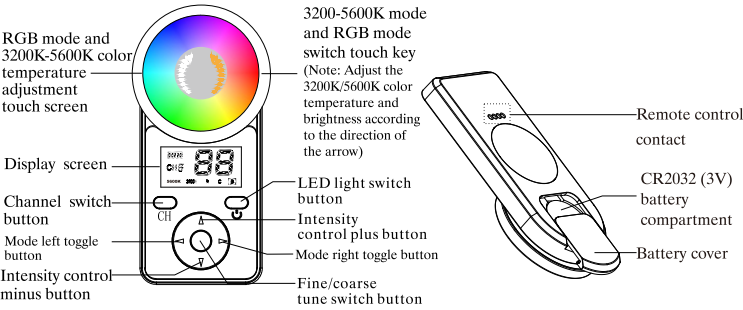

Installation and fixed

- 1.Battery Installation
When installing the lithium battery, please put the battery into the slot in the direction of the arrow.
Note: NP-F series battery is applicable, please remove the battery when not in use.

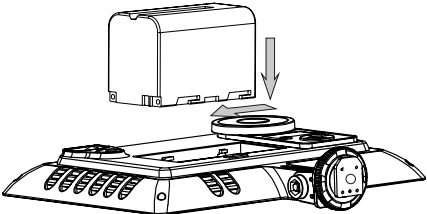

- b. When removing the lithium batteries, please press the battery lock and then take out the lithium batteries.

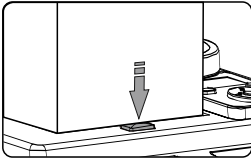

- 2.Camera Light Installation
Firstly, fasten the lamp base to the bottom of the product with the adjusting screw and then adjusting the angle of the lamp as needed.

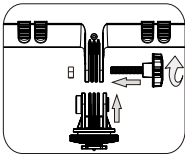

- 3.The camera lamp can be fastened as the following methods according to your requirement:
a. Fix on the DSLR/Camera hot shoe.

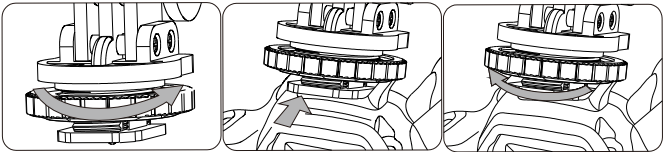

- ① Screw the hot shoe fastening knob to the top in the direction of the arrow.
- ② Insert the lamp into the camera/camera hot shoe base in the direction of the arrow.
- ③ Tighten up the hot shoe knob in the direction of arrow.

- b. Place it on the desktop or on a plane, and use it with the miniature stand attached.

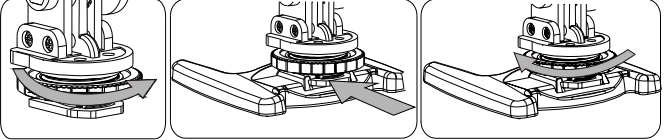

- ① Rotate the hot-shoe lock knob to the top in the direction of the arrow.
- ② Push the metal hot-shoe on the lamp foot in the miniature stand in the direction of the arrow.
- ③ Screw up the hot-shoe lock knob in the direction of the arrow.

4.External Power Supply

It is recommended to use YONGNUO power adapter with YN300Air II to obtain lasting service time. When using external power supply, the video light will stop the battery power supply automatically and will not get the battery charged. The external power supply interface outside is positive and the interface inside is negative. The input voltage is 12V and the electric current is 2A.
Note: If YN300Air II defective when it is used with power adapter of other brands, YN300Air II will no longer be guaranteed for repair.

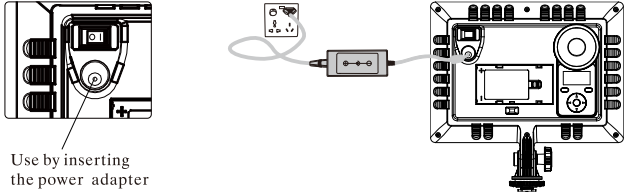

5. Put the remote control into the video light card slot to use.
When the remote-controller is not equipped with batteries, insert the remote-controller into the video card slot, you can use it when the remote control iron plate and the camera light magnet absorbed together. If remotely control the video light needed, install a CR2032 battery to the remote control.

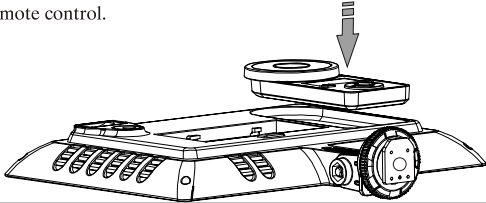

Method Application

- 1.Startup & Shutdown Button
Install the batteries or insert the DC power supply, and then press the power switch, the LED video light lights up. Put the remote controller into the LED video light and use it to adjust the brightness. Note:the RGB color mode and the 3200K-5600K color temperature Mode can not be used at the same time.

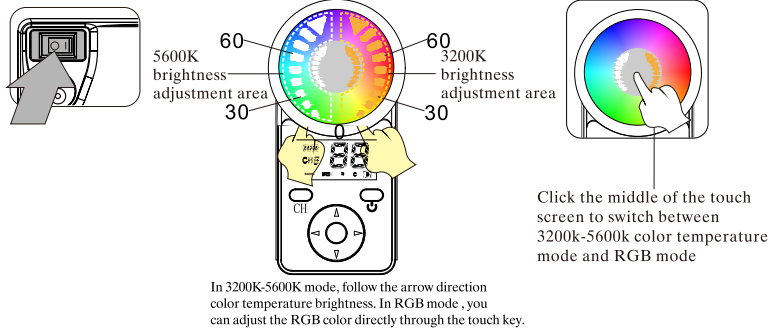

2. Power test
Insert the remote control into the video light card slot, the remote control displays the battery power for the video light. The battery power is 41% to 60% as shown below.

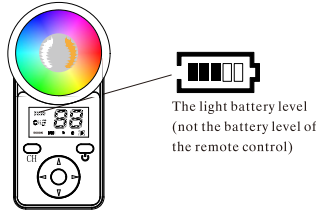

- 3.Coarse/Fine adjusting Switch Button
Fine/Coarse Tune Mode Press fine/coarse tune button on the remote cotroller to switch the tune mode. When the tune mode is switched to coarse tune mode, the adjusting unit of the brightness is 10%; when it's fine tune mode, the adjusting unit is 1%.
Note: Press and hold the 2 second coarse/fine button to lock the touch screen to avoid mistake touch; long press again to unlock.

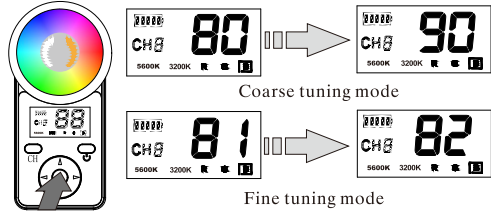

- 4.Switch color temperature mode
Press the left and right buttons of remote control to switch the color temperature mode.

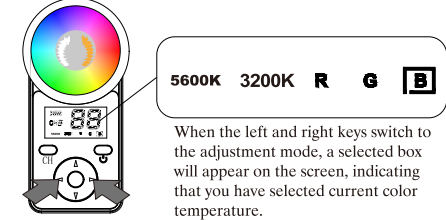

5.Channel switch button

- A. Put the remote controller into the card slot of the video light, short press [CH] button on the controller, and, the video light and the controller synchronously CH+, the controller will be switched to the channel needed. When you take the controller off, the channel of the video light and the channel of the controller is consistent.
- B. For example, if the channel of the controller is switched to channel CH2, the channel of the video light is CH2; when you take the controller off, the channel of the video light is as well CH2. To switch the channel of the video light, the remote controller should be inserted to the card slot of the video light.
- C. If you possess several YN300Air II, you can group control the brightness and switches; the groups at most is 8 groups.
(The LCD screen of the remote control can display the number of CH1-8. each number corresponds to the corresponding channel, you can change the channel through the CH button.)

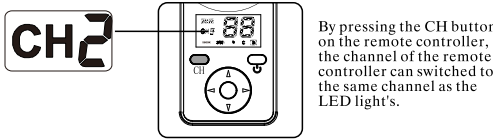

6.Special Scene Supplementary Lighting Mode

- A. Long press CH button for 2 seconds to enter special scene mode ,F0 displays.
- B. Short press CH button to switch F0-F9 (10 scenes) or left right button to switch 10 different scenes.
- C,Short press coarse/fine tuning switch button to pause or start the special scene supplementary lighting.
- D,Long press CH button to exit or power off and exit.

- | | |
|---|--|
| F0.Simulates lightning | F5.Rapid cycle among red, green, blue |
| F1.Simulates movie screen reflect light | F6.Slow cycle among red, green, blue |
| F2.Simulates candlelight | F7.Simulates police car light |
| F3.Simulates sunrise | F8.Simulates ambulance light |
| F4.Simulates firework | F9.Simulates fire fighting truck light |

Failure Analysis and Troubleshooting

When using this product, you may encounter the following problems.

| Description | Cause | Troubleshooting |
|---|---|--|
| No reaction after power on | Low Battery | Install new batteries or connect external power supply |
| | Damaged circuit board | Depot repair |
| Inadequate or low luminance at the greatest luminous intensity | Low battery | Install new batteries or re-charge the batteries |
| Inaccurate battery capacity test; low battery in high luminance and full battery in low luminance. | The battery capacity indicates the length of time available for the use in the current luminance. Higher luminance required more power and the length of time available for use will be shortened, so the battery capacity shown gets lower | Normal phenomenon and no measure needed |
| The mobile phone could not remote control the video light | Too far away | The remote control distance is within 15 meters |
| When press the remote control button, the light responds, the RGB touch adjustment, the light does not respond. | Remote controller has a low battery | Replace the remote controller with a new battery |

The functions in this manual are based on the test conditions our company.Further notice will not be given if the design and specifications change.
SHENZHEN YONGNUO PHOTOGRAPHY EQUIPMENT Co.Ltd.
Add:Building A, Shenfubao modern optics factory,Kengzi Street, Pingshan District, Shenzhen
TEL:0755-8376 2448
Wed:www.hkyongnuo.com
After-sales Service TEL:400-0013-888